

KL-1911 4.5mm CO2 Ver. Schematic

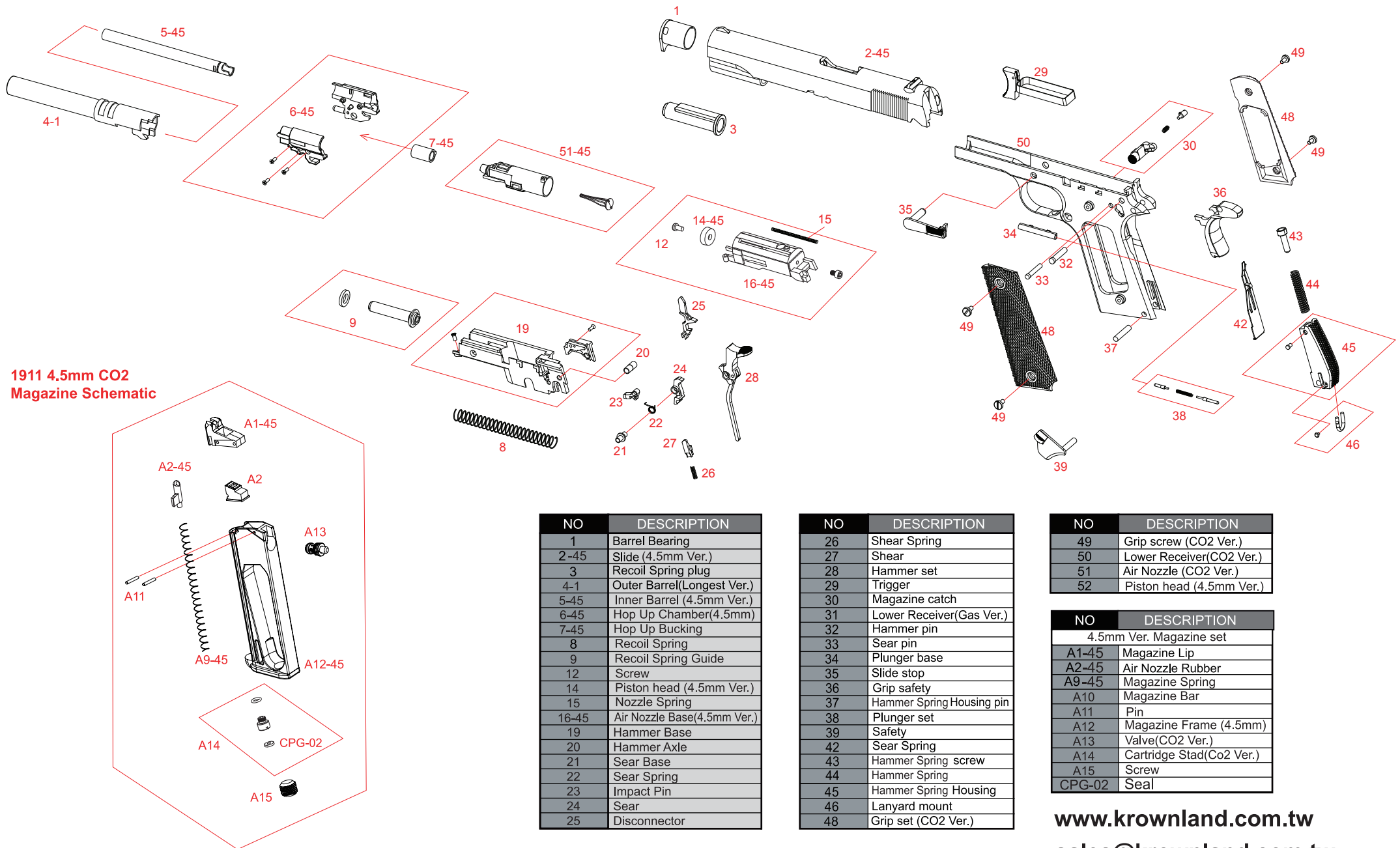

1911 4.5mm CO2 Magazine Schematic

| NO | DESCRIPTION |
|-------|-----------------------------|
| 1 | Barrel Bearing |
| 2-45 | Slide (4.5mm Ver.) |
| 3 | Recoil Spring plug |
| 4-1 | Outer Barrel(Longest Ver.) |
| 5-45 | Inner Barrel (4.5mm Ver.) |
| 6-45 | Hop Up Chamber(4.5mm) |
| 7-45 | Hop Up Bucking |
| 8 | Recoil Spring |
| 9 | Recoil Spring Guide |
| 12 | Screw |
| 14 | Piston head (4.5mm Ver.) |
| 15 | Nozzle Spring |
| 16-45 | Air Nozzle Base(4.5mm Ver.) |
| 19 | Hammer Base |
| 20 | Hammer Axle |
| 21 | Sear Base |
| 22 | Sear Spring |
| 23 | Impact Pin |
| 24 | Sear |
| 25 | Disconnecter |

| NO | DESCRIPTION |
|----|---------------------------|
| 26 | Shear Spring |
| 27 | Shear |
| 28 | Hammer set |
| 29 | Trigger |
| 30 | Magazine catch |
| 31 | Lower Receiver(Gas Ver.) |
| 32 | Hammer pin |
| 33 | Sear pin |
| 34 | Plunger base |
| 35 | Slide stop |
| 36 | Grip safety |
| 37 | Hammer Spring Housing pin |
| 38 | Plunger set |
| 39 | Safety |
| 42 | Sear Spring |
| 43 | Hammer Spring screw |
| 44 | Hammer Spring |
| 45 | Hammer Spring Housing |
| 46 | Lanyard mount |
| 48 | Grip set (CO2 Ver.) |

| NO | DESCRIPTION |
|----|--------------------------|
| 49 | Grip screw (CO2 Ver.) |
| 50 | Lower Receiver(CO2 Ver.) |
| 51 | Air Nozzle (CO2 Ver.) |
| 52 | Piston head (4.5mm Ver.) |

| NO | DESCRIPTION |
|-------------------------|--------------------------|
| 4.5mm Ver. Magazine set | |
| A1-45 | Magazine Lip |
| A2-45 | Air Nozzle Rubber |
| A9-45 | Magazine Spring |
| A10 | Magazine Bar |
| A11 | Pin |
| A12 | Magazine Frame (4.5mm) |
| A13 | Valve(CO2 Ver.) |
| A14 | Cartridge Stad(Co2 Ver.) |
| A15 | Screw |
| CPG-02 | Seal |

www.krownland.com.tw
sales@krownland.com.tw